

Coaxial RF Load Connector Datasheet

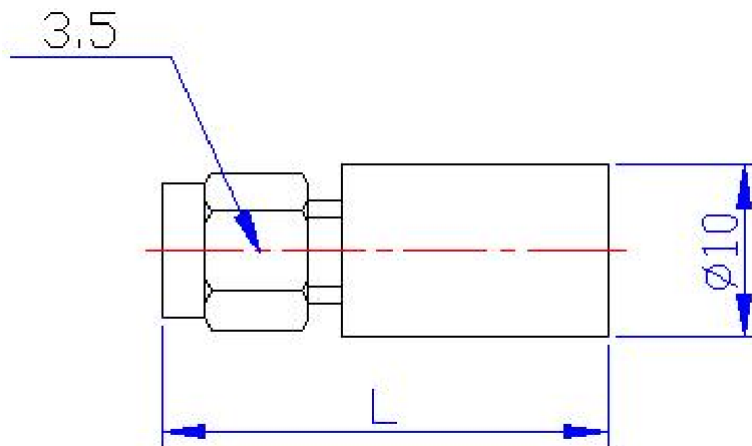

RL3.5-J-2-WH



dimensions are in mm

Configuration

Connector Type	3.5 Male
Outer Contact	Stainless Steel Passivation
Center Contact	Beryllium Copper, Gold

Electrical Characteristics

Impedance	50Ω
Frequency Range	DC to 26.5GHz
VSWR (Voltage Standing Wave Ratio)	≤1.35, DC to 26.5GHz
Power (Avg)	2 Watt

Environment Data

Working Temperature	-55℃ ~ +125℃
Weight	8 g
Overall Dimension	Ø10×L=23.6mm
Environmental Standards	RoHS

Order Information

Order P/N	Description
RL3.5-J-2-WH	3.5 Male RF Load,2W DC-26.5GHz