

# High frequency probe GS(SG) configuration

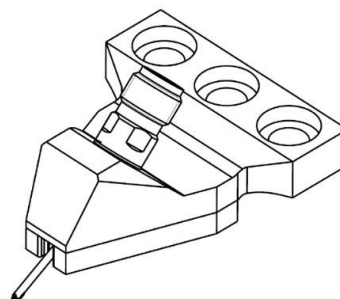
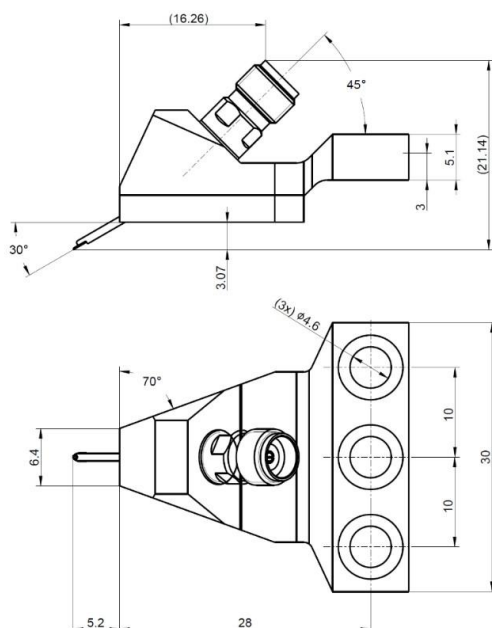

all the dimensions are in mm.

## Configuration

Connector	2.92 female
Probe Material:	
-Probe tip	Nickel alloy, Gold plating (Au pads)
-Body	Aluminum Alloy
-Insulator	PEEK
Recommend Overtravel	50um~75um

## Electrical Characteristics

Impedance	50 $\Omega$
Frequency Range	DC to 40 GHz
Return Loss	>15 dB @ DC to 40 GHz, based on 100um pitch
Insertion Loss	<0.7 dB @ DC to 40 GHz, based on 100um pitch
Contact resistance	< 50 m $\Omega$ , Au pads; < 75 m $\Omega$ , Al pads

## Environment Data

Working Temperature	-45°C to +85°C
RoHS	Compliant

## Order Information

P/N	Description
2.92-A-GS-150	45 Angle GS Probe, GS configuration, 150 um pitch, DC to 40GHz
2.92-A-SG-150	45 Angle SG Probe, SG configuration, 150 um pitch, DC to 40GHz
2.92-A-GS-xxx	45 Angle GS Probe, GS configuration, xxx um pitch, DC to 40GHz
2.92-A-SG-xxx	45 Angle SG Probe, SG configuration, xxx um pitch, DC to 40GHz