

# High frequency probe 110GHz, GSG configuration

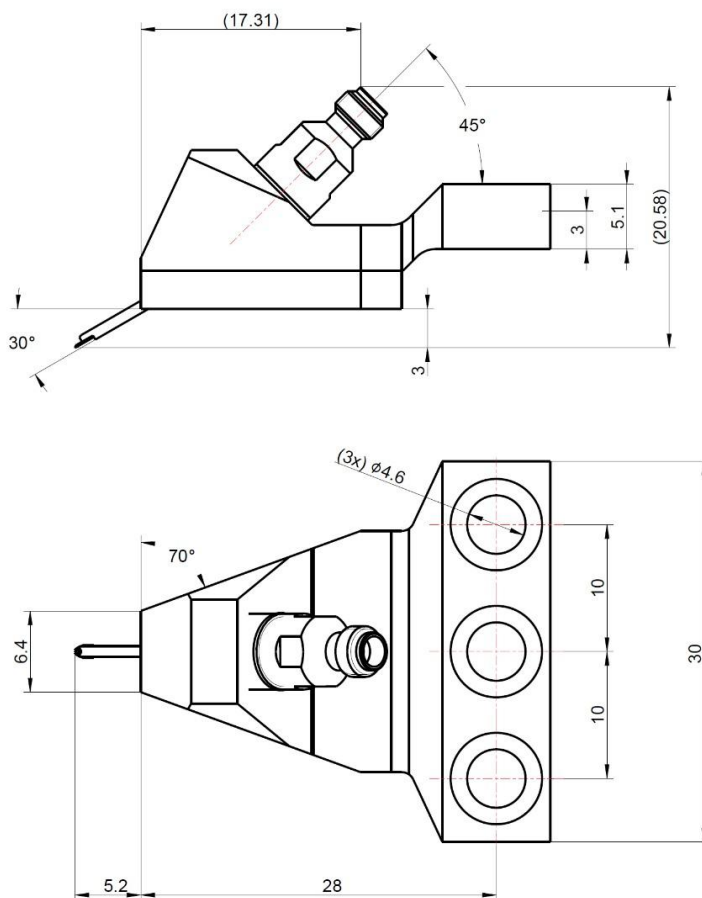

- all the dimensions are in mm. Tolerance: +/-0.25

## Configuration

Connector	1.0 female
Probe Material:	
-Probe tip	Nickel alloy, Gold plating
-Body	Aluminum Alloy
Probe tip width	30um
Recommend Overtravel	50um~75um

## Electrical Characteristics

Impedance	50 $\Omega$
Frequency Range	DC to 110 GHz
Return Loss	>12 dB @ DC to 110 GHz, based on GSG 150um pitch
Insertion Loss	<1.3 dB @ DC to 110 GHz, based on GSG 150um pitch

# High frequency probe

## 110GHz, GSG configuration



### Environment Data

Working Temperature	-45℃ to +85℃
RoHS	Compliant

### Test Data

Typical RF performance based on 150um pitch!

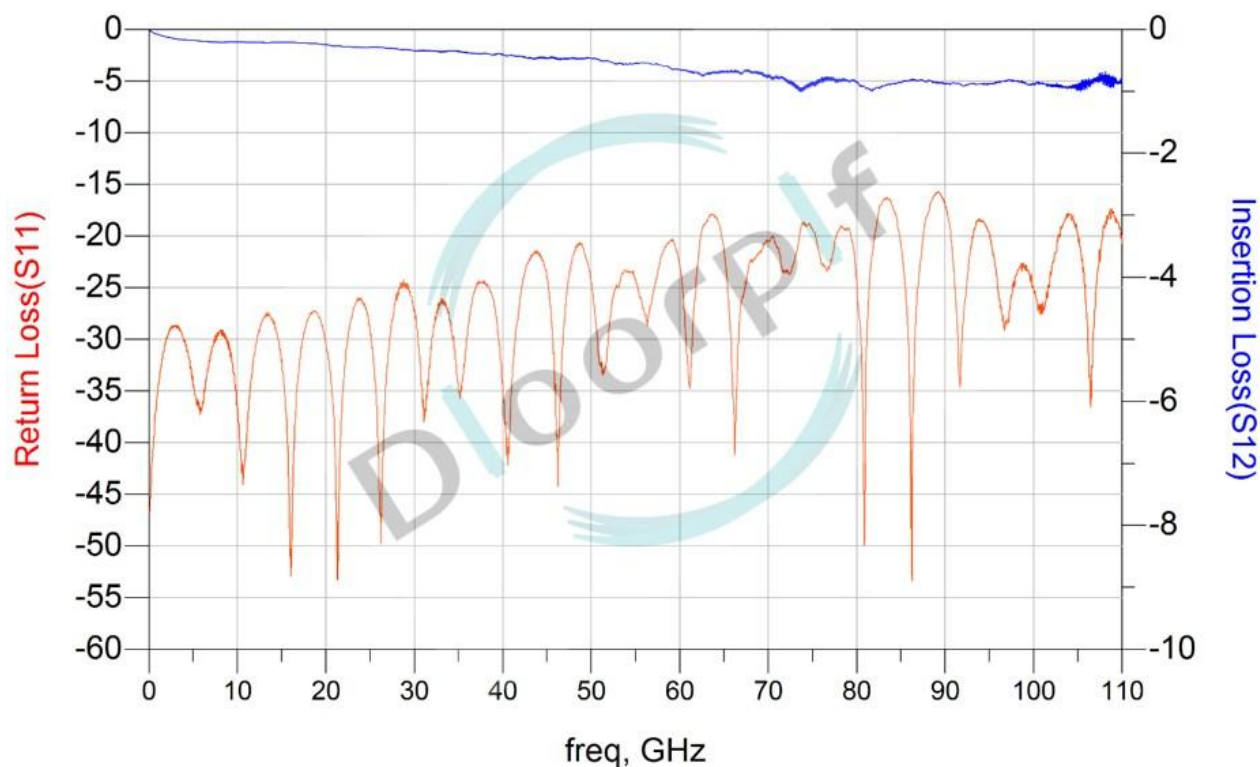

### Order Information

P/N	Description
<b>1.0-A-GSG-50</b>	45 Angle GSG Probe, 50 um pitch, DC to 110 GHz
<b>1.0-A-GSG-75</b>	45 Angle GSG Probe, 75 um pitch, DC to 110 GHz
<b>1.0-A-GSG-100</b>	45 Angle GSG Probe, 100 um pitch, DC to 110 GHz
<b>1.0-A-GSG-150</b>	45 Angle GSG Probe, 150 um pitch, DC to 110 GHz
<b>1.0-A-GSG-xxx</b>	45 Angle GSG Probe, xxx um pitch, DC to 110 GHz